



Recognized for Expertise

Seal-less **Magnetic**  
Drive Process **Pumps**



Product Catalogue  
[www.astronpumpsindia.com](http://www.astronpumpsindia.com)

**Astron Pumps & Equipments Pvt. Ltd.** is a family-owned company founded in 1995 for manufacturing spares of centrifugal pumps for the Chemical, Food, Beverage, Pharmaceutical, Engineering, Pulp & Paper, Power plant, Textile industries & etc.

After researching more & more, Astron founders and the R&D team have innovated a new product named Seal-less Magnetic Drive Process Pump to fulfill customer requirements.

With this innovative product, we hope that this pump should work as soon as possible in the market & every customer gets satisfaction with this newer product.

Our Manufacturing facility is Located at Kanodar, Gujarat(India) comprising high precision CNC lathe and CNC VMC machines.

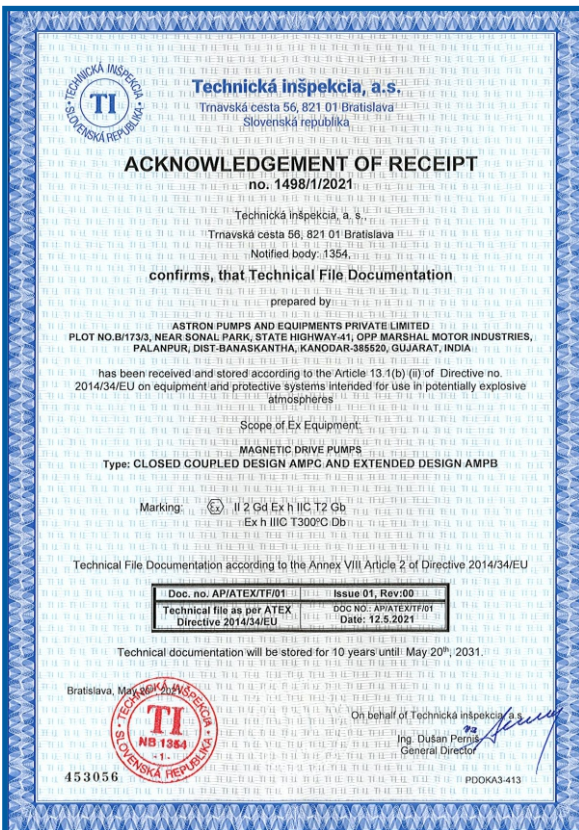

### Our Vision

With integrity, respect, and a deep commitment to consistently deliver exceptional performance in Magnetic Drive Process Pumps, it is our goal to develop a distinctive business strategy that succeeds for our clients.



### Our Mission

Astron's Mission is to provide customers with the most cost-effective magnetic drive pump solution through a technologically most reliable product. We will satisfy our Customers, Employees, Stakeholders, Community, and Society.



### Customer Service

Astron doesn't just believe in slogan but it's a companywide commitment always remains most importantly customer focus. Astron team member will direct you to specific resource right away to provide a solution that meets technical and commercial requirement. Customer has been a key component to our exceptional customer service.

### Features :

- **Single Stage Horizontal** Centrifugal pump
- Pumps designed according to **DIN EN ISO 2858**
- Specially developed **Magnets** for longer life
- **Double bearing cartridge** design for better performance
- Hydraulically **balanced impeller** for **minimum bearing loads**
- Simple modular construction for **ease of maintenance**
- **Back pullout** design to facilitate inspection and maintenance
- High level of **durability and reliability**
- Optional **dry run relay** available
- Options for **leak detection** are available that **eliminate any leakage to the environment**



### Benefits :

- **As harmful or risky liquids**, exotic liquids, acids, alkalis, corrosives, contaminants, and toxics are pumped, **magnetic drive pumps are commonly utilized**.
- Ideal for ultra-pure liquids and liquids that are difficult to seal.
- **To prevent hazardous liquids** from leaking to the surroundings, sealed pumps used in these types of services can leak over time or require complicated, **costly double seals**, which can result in safety hazards, downtime and **increased maintenance requirements**.
- Very much suitable for liquids that crystallize on mechanical seal faces which causes seal failure. **To avoid this flush system is used which increases the cost of maintenance, energy consumption, and seal flushing liquids**.
- As there is **no Mechanical seal**, it improves pump performance, reliability, and availability of pump.
- **Removing the seals** also prevents **friction loss, wear, costs and noise**.
- **The magnetic coupling will soften any shock or spike torques**. Even in extreme situations, it will act as a fuse.
- Since the **pump chamber is isolated** from the electric motor by a wide air gap, there is virtually **no heat transfer from the electric motor**.

## AMPC Series

### SS Magnetic Drive Process Pump (Close Couple)

#### Specifications

Flow upto	:	max. 300 m <sup>3</sup> /h or max. 79251.6 US gph
Head upto	:	max. 100 m or 328 Ft
Max. Motor power	:	55 kW or 75 HP
Temperature Range	:	-35°C to +350°C
Max. Working Pressure	:	PN16 / PN25
Max. Kinematic Viscosity	:	0.5 to 350 mm <sup>2</sup> /s
Solid Handling Range	:	5% hard Solids Up to 150 microns diameter
Flange Class	:	Class 150
Drive	:	Close Couple
Impeller Type	:	Close
Magnets	:	Ferrite/Rare Earth/Specially Designed
MOC	:	WCB, SS304, SS316, SS316L, Hastelloy, C.I., Duplex, etc.



#### Technical Data Table

Pump Model	2 POLE (2900 RPM)			4 POLE (1450 RPM)		
	Nominal Duty Point		Motor	Nominal Duty Point		Motor
	Q m <sup>3</sup> /h	H m	hp / kw	Q m <sup>3</sup> /h	H m	hp/kw
AMPC 25 x 25-125	4	20	1/0.75	2	5	0.25/0.18
AMPC 32 x 25-125	5	20	1.5/1.1	3	5	0.25/0.18
AMPC 50 x 32-125	12.5	20	3/2.2 - 5/3.7	6.3	5	0.5/0.37
AMPC 65 x 40-125	25	20	5/3.7 - 7.5/5.5	12.5	5	1/0.75
AMPC 80 x 50-125	50	20	7.5/5.5 - 10/7.5	25	5	1.5/1.1
AMPC 32 x 25-150	5	30	2/1.5	3	10	0.5/0.37
AMPC 50 x 32-160	12.5	32	5/3.7 - 7.5/5.5	6.3	8	1/0.75
AMPC 65 x 40-160	25	32	7.5/5.5 - 10/7.5	12.5	8	1.5/1.1
AMPC 80 x 50-160	50	32	12.5/9.3 - 15/11	25	8	2/1.5
AMPC 50 x 32-200	12.5	50	10/7.5 - 12.5/9.3	6.3	12.5	1.5/1.1
AMPC 65 x 40-200	25	50	12.5/9.3 - 15/11	12.5	12.5	2/1.5
AMPC 80 x 50-200	50	50	20/15 - 30/22.5	25	12.5	4/3
AMPC 50 x 32-250	12.5	80	15/11 - 20/15	6.3	20	3/2.2
AMPC 65 x 40-250	25	80	20/15 - 30/22.5	12.5	20	4/3

General Assembly Drawing

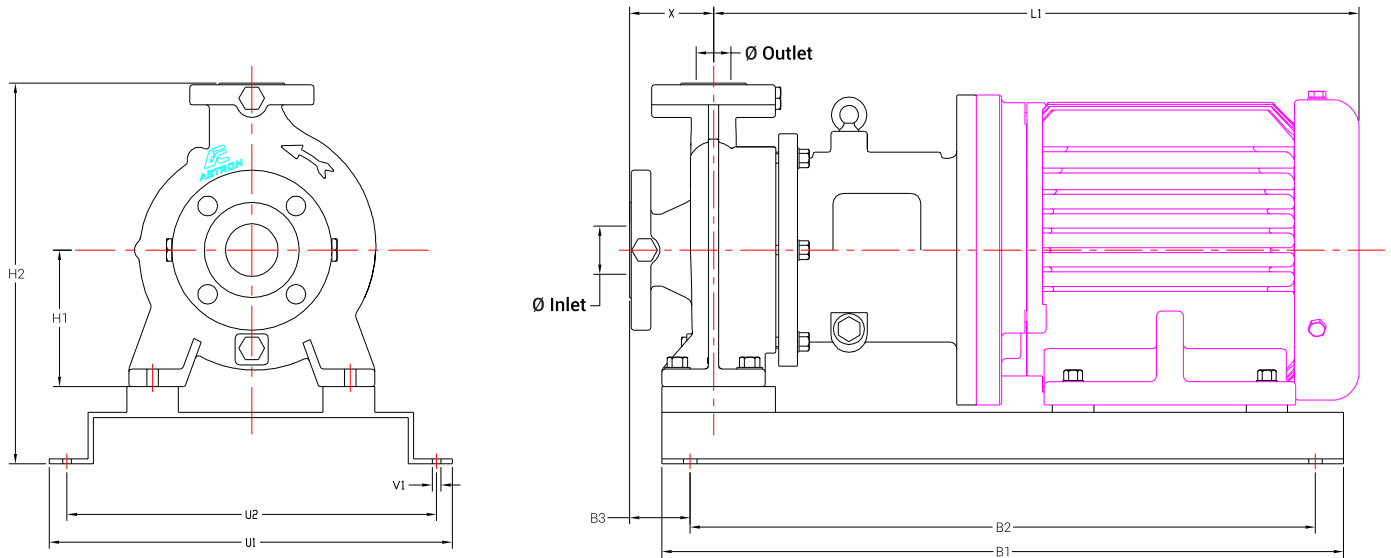

Dimension Table

Pump Model	Size Description			Dimension In Millimeters									
	Ø Inlet mm	Ø Outlet mm	Impeller (nominal) mm	Pump				Support					
				X	L1	H1	H2	B1	B2	B3	U1	U2	V1
AMPC 25 x 25-125	25	25	125	82	425	112	340	465	405	62	300	270	Ø16
AMPC 32 x 25-125	32	25	125	82	475	112	340	465	405	62	300	270	Ø16
AMPC 50 x 32-125	50	32	125	80	665	112	338	604	554	46	338	308	Ø16
AMPC 65 x 40-125	65	40	125	80	665	112	338	604	554	46	338	308	Ø16
AMPC 80 x 50-125	80	50	125	100	700	132	380	650	600	50	338	308	Ø16
AMPC 32 x 25-150	32	25	150	82	475	112	340	465	405	62	300	270	Ø16
AMPC 50 x 32-160	50	32	160	80	665	132	380	604	554	46	338	308	Ø16
AMPC 65 x 40-160	65	40	160	80	665	132	380	604	554	46	338	308	Ø16
AMPC 80 x 50-160	80	50	160	100	800	160	430	650	600	50	338	308	Ø16
AMPC 50 x 32-200	50	32	200	80	720	160	430	700	675	50	350	320	Ø16
AMPC 65 x 40-200	65	40	200	100	800	160	430	700	675	50	350	320	Ø16
AMPC 80 x 50-200	80	50	200	100	900	160	470	750	700	50	450	410	Ø16
AMPC 50 x 32-250	50	32	250	100	800	180	490	700	675	50	400	370	Ø16
AMPC 65 x 40-250	65	40	250	100	850	180	500	750	700	50	450	410	Ø16

## AMPB Series

### SS Magnetic Drive Process Pump (Long Couple)

#### Specifications

Flow upto	:	max. 300 m <sup>3</sup> /h or max. 79251.6 US gph
Head upto	:	max. 100 m or 328 Ft
Max. Motor power	:	55 kW or 75 HP
Temperature Range	:	-35°C to +350°C
Max. Working Pressure	:	PN16 / PN25
Max. Kinematic Viscosity	:	0.5 to 350 mm <sup>2</sup> /s
Solid Handling Range	:	5% hard Solids Up to 150 microns diameter
Flange Class	:	Class 150
Drive	:	Long Couple
Impeller Type	:	Close
Magnets	:	Ferrite/Rare Earth/Specially Designed
MOC	:	WCB, SS304, SS316, SS316L, Hastelloy, C.I., Duplex, etc.



#### Technical Data Table

Pump Model	2 POLE (2900 RPM)			4 POLE (1450 RPM)		
	Nominal Duty Point		Motor	Nominal Duty Point		Motor
	Q m <sup>3</sup> /h	H m	hp / kw	Q m <sup>3</sup> /h	H m	hp/kw
AMPB 25 x 25-125	4	20	1/0.75	2	5	0.25/0.18
AMPB 32 x 25-125	5	20	1.5/1.1	3	5	0.25/0.18
AMPB 50 x 32-125	12.5	20	3/2.2 - 5/3.7	6.3	5	0.5/0.37
AMPB 65 x 40-125	25	20	5/3.7 - 7.5/5.5	12.5	5	1/0.75
AMPB 80 x 50-125	50	20	7.5/5.5 - 10/7.5	25	5	1.5/1.1
AMPB 100 x 65-125	100	20	12.5 / 9.3	50	5	3 / 2.2
AMPB 32 x 25-150	5	30	2/1.5	3	10	0.5/0.37
AMPB 50 x 32-160	12.5	32	5/3.7 - 7.5/5.5	6.3	8	1/0.75
AMPB 65 x 40-160	25	32	7.5/5.5 - 10/7.5	12.5	8	1.5/1.1
AMPB 80 x 50-160	50	32	12.5/9.3 - 15/11	25	8	2/1.5
AMPB 100 x 65-160	100	32	20 / 15	50	8	5 / 3.7
AMPB 50 x 32-200	12.5	50	10/7.5 - 12.5/9.3	6.3	12.5	1.5/1.1
AMPB 65 x 40-200	25	50	12.5/9.3 - 15/11	12.5	12.5	2/1.5
AMPB 80 x 50-200	50	50	20/15 - 30/22.5	25	12.5	4/3
AMPB 100 x 65-200	100	50	40 / 30	50	12.5	7.5 / 5.5
AMPB 50 x 32-250	12.5	80	15/11 - 20/15	6.3	20	3/2.2
AMPB 65 x 40-250	25	80	20/15 - 30/22.5	12.5	20	4/3
AMPB 80 x 50-250	50	80	50 / 37	25	20	7.5 / 5.5
AMPB 100 x 65-250	100	80	60 / 45	50	20	10 / 7.5

## General Assembly Drawing

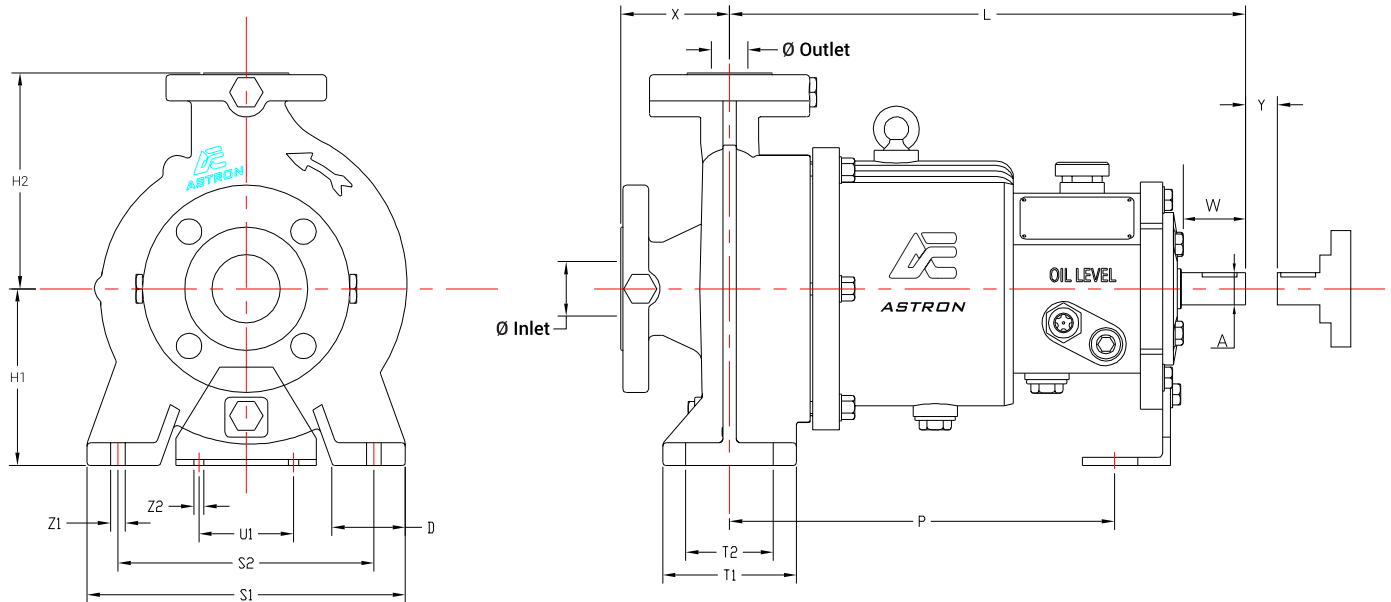

## Dimension Table

Pump Model	Size Description			Dimension In Millimeters															
	Ø Inlet mm	Ø Outlet mm	Impeller (nominal) mm	Pump					Support					P	Clearance Holes For Bolts		Shaft End		
				X	L	H1	H2	D	T1	T2	S1	S2	U1		Z1	Z2	A	W	Y
AMPB 25 x 25-125	25	25	125	80	332	112	142	50	100	80	190	140	50	270	M12	M12	20	35	15
AMPB 32 x 25-125	32	25	125	80	332	112	142	50	100	80	190	140	50	270	M12	M12	20	35	15
AMPB 50 x 32-125	50	32	125	80	385	112	140	50	100	70	190	140	110	285	M12	M12	24	50	100
AMPB 65 x 40-125	65	40	125	80	385	112	140	50	100	70	210	160	110	285	M12	M12	24	50	100
AMPB 80 x 50-125	80	50	125	100	385	132	160	50	100	70	240	190	110	285	M12	M12	24	50	100
AMPB 100 x 65-125	100	65	125	100	385	160	180	65	125	95	280	212	110	285	M12	M12	24	50	100
AMPB 32 x 25-150	32	25	150	80	332	112	142	50	100	80	190	140	50	270	M12	M12	20	35	15
AMPB 50 x 32-160	50	32	160	80	385	132	160	50	100	70	240	190	110	285	M12	M12	24	50	100
AMPB 65 x 40-160	65	40	160	80	385	132	160	50	100	70	240	190	110	285	M12	M12	24	50	100
AMPB 80 x 50-160	80	50	160	100	385	160	180	50	100	70	265	212	110	285	M12	M12	24	50	100
AMPB 100 x 65-160	100	65	160	100	500	160	200	65	125	95	280	212	110	370	M12	M12	32	80	100
AMPB 50 x 32-200	50	32	200	80	385	160	180	50	100	70	240	190	110	285	M12	M12	24	50	100
AMPB 65 x 40-200	65	40	200	100	385	160	180	50	100	70	265	212	110	285	M12	M12	24	50	100
AMPB 80 x 50-200	80	50	200	100	385	160	200	50	100	70	265	212	110	285	M12	M12	24	50	100
AMPB 100 x 65-200	100	65	200	100	500	180	225	65	125	95	320	250	110	370	M12	M12	32	80	140
AMPB 50 x 32-250	50	32	250	100	500	180	225	65	125	95	320	250	110	370	M12	M12	32	80	100
AMPB 65 x 40-250	65	40	250	100	500	180	225	65	125	95	320	250	110	370	M12	M12	32	80	100
AMPB 80 x 50-250	80	50	250	125	500	180	225	65	125	95	320	250	110	370	M12	M12	32	80	100
AMPB 100 x 65-250	100	65	250	125	500	200	250	80	160	120	360	280	110	370	M16	M12	32	80	140

## 2 POLE - 2900 RPM

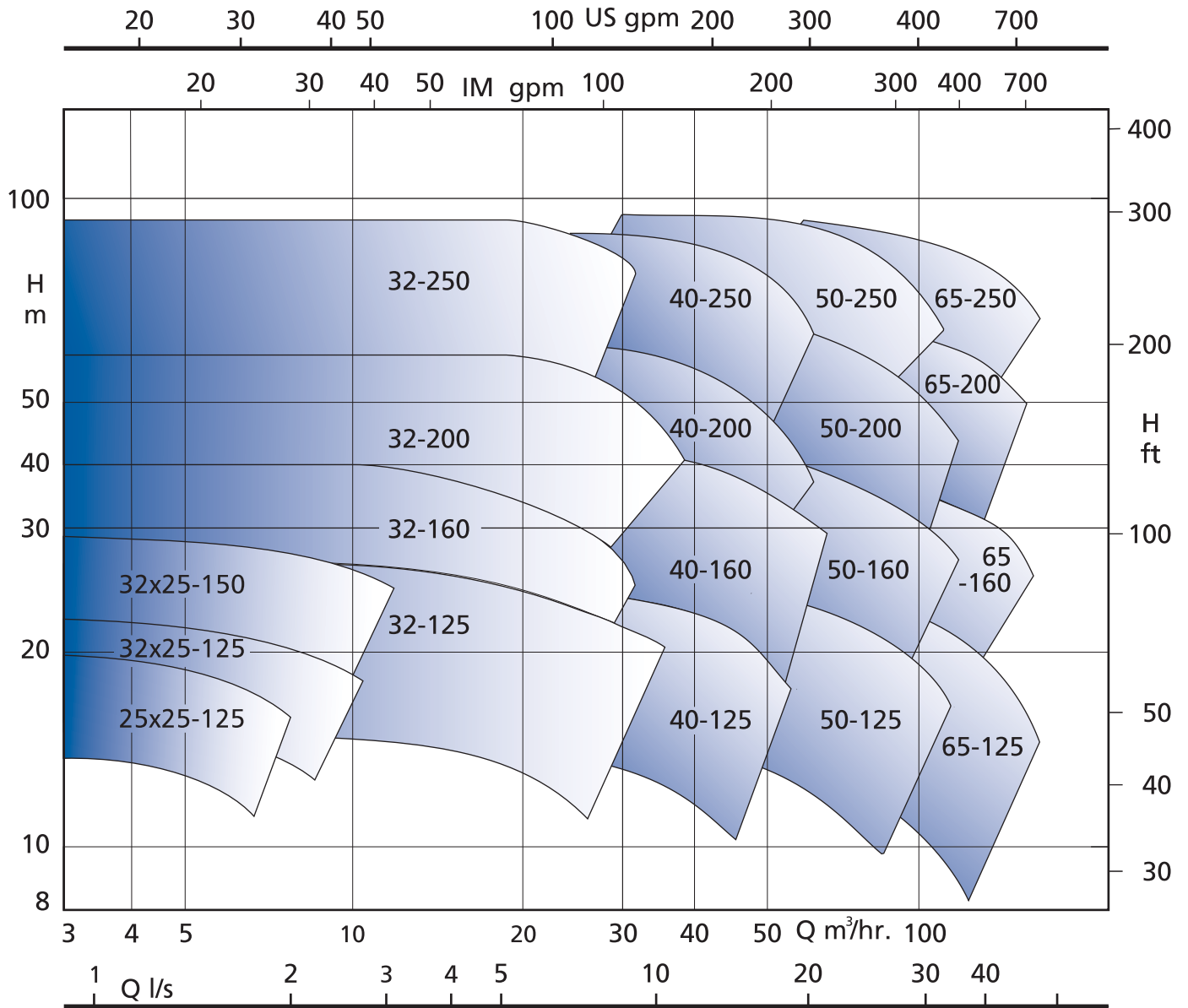

### Application

- Acid/Base Pumps
- Chemical Feed/Process/Transfer Pumps
- Hot Oil Pumps
- High/Low Temperature pumps
- High Purity Water Pumps
- Pharma Liquid/Solution Pump
- Solvent Transfer
- Boiler Feed Pump
- Desalination Pumps
- Caustic Pumps
- Coolant Pumps
- Fertilizer Pump



# 4 POLE - 1450 RPM

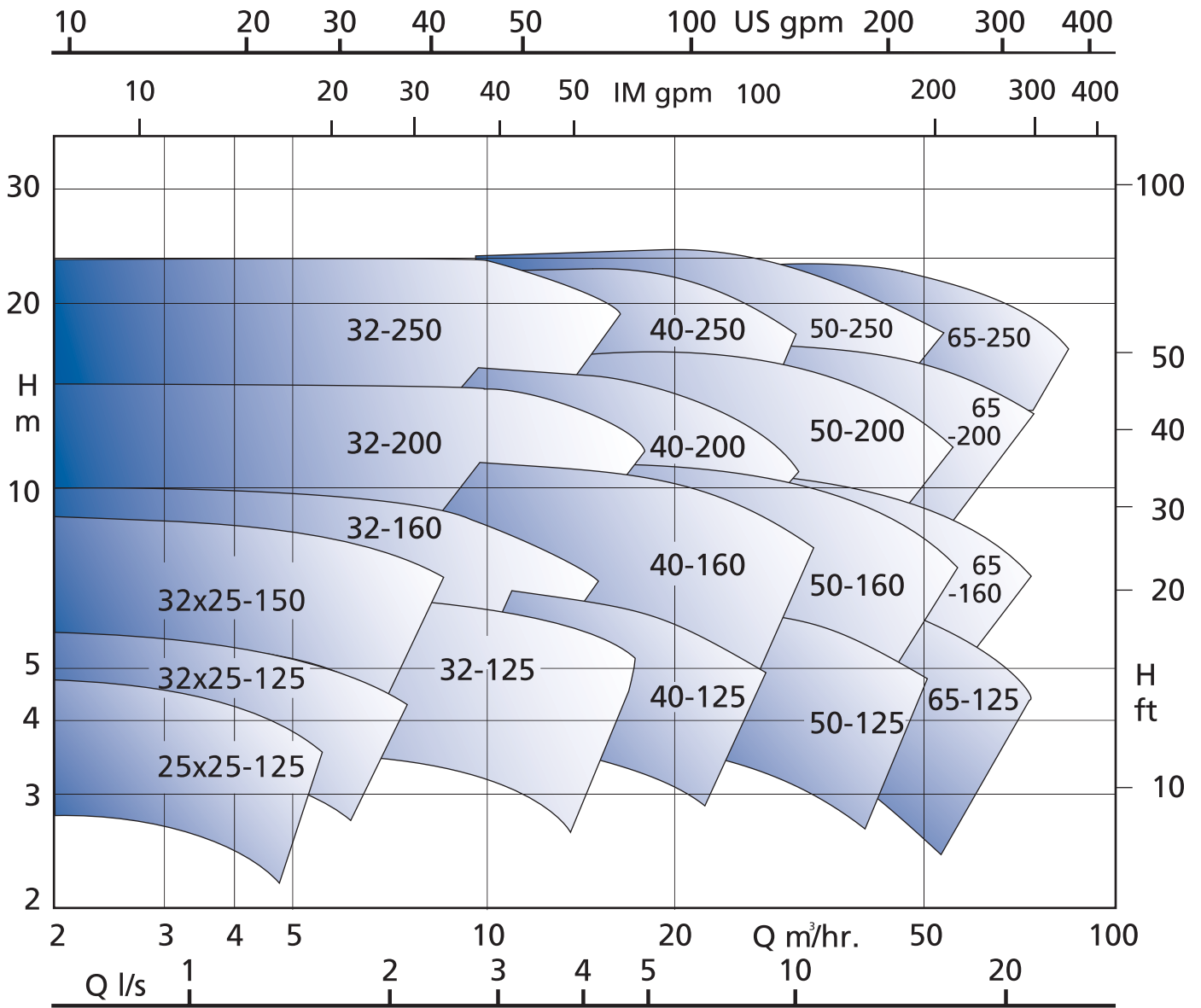

## Industries We Serve



Chemical Industry

Pharmaceutical Industry

Food & Beverage Industry

Water & Wastewater Industry

Paper & Pulp Industry

Agrochemical Industry

## AMPC Series Model

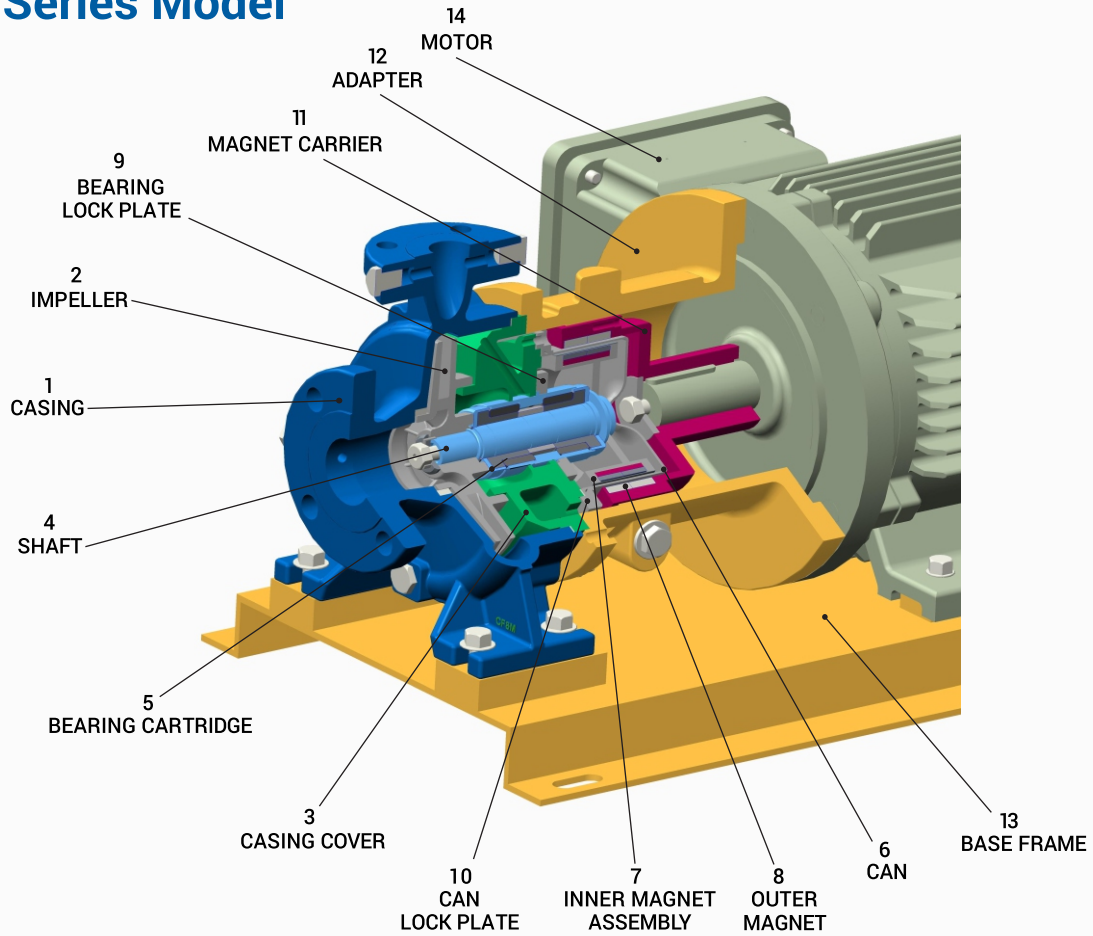

### List Of Components With MOC

Item No.	Description	Material
1	CASING	SS304 / SS304L / SS316 / SS316L DUPLEX ALLOY / HASTELLOY
2	IMPELLER	
3	CASING COVER	
4	SHAFT	SS304 / SS316 / SS316L
5	BEARING CARTRIDGE	SIC + TC +TC + SS316
6	CAN	SS316L / HAST-C
7	INNER MAGNET ASSEMBLY	FERRITE & SPECIAL MAGNET
8	OUTER MAGNET	FERRITE & SPECIAL MAGNET
9	BEARING LOCK PLATE	SS304 / SS316
10	CAN LOCK PLATE	SS304 / SS316
11	MAGNET CARRIER	CI / WPS
12	ADAPTER	CI / WPS
13	BASE FRAME	MS
14	FLAMEPROOF / NON-FLAMEPROOF MOTOR	CROMPTON / ABB / AS PER CLIENT REQUIREMENT
	GASKET	PTFE
	FASTENERS	SS304 / SS316 / SS316L

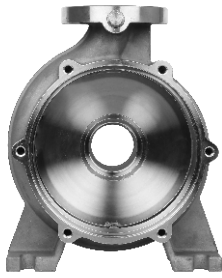

### Volute Casing

One of the most important part of this innovative pump whose casting is totally checked by dye penetration test. It's overall machining portions are done on CNC & VMC machines for the better accuracy.



### Impeller

This spare is inspected by Dynamic balancing machine based on API standards. Until acceptance criteria of balancing should not meets, our engineer continues working on grinding and balancing it.



### Casing Cover

It is located between impeller and bearing housing with the help of fastener at a tightening torque standard condition. After completely machined on our accurate machinery, hydro test machine is used to check the fluid pressure at standard pressure conditions and also verify that leakage problem is present or not.



### Containment Shell

Fitted to magnetically coupled pump between external magnetic carrier connected to the motor and the internal magnetic carrier connected to the pump rotor. It is design as per working pressure of pump in various MOC such as SS316, SS316L, Hastelloy, etc. Designed pressure is 5kg to 15kg.



## ASTRON PUMPS AND EQUIPMENTS PVT. LTD.

### OFFICE & MFG. UNIT

Plot No. B/173/3, Nr. Sonal Park, State Highway-41,  
Palanpur, Dist-banaskantha, Kanodar-385520,  
Gujarat. INDIA  
Tel. +91-9601584988 / +91-9601584989

### MUMBAI OFFICE

1A, 1<sup>st</sup> Floor, Sadhana Industrial Estate, Oshiwara,  
S.V.Road, Jogeshwari (w), Mumbai-400102.  
Tel. +91-98194 44235 / 98332 94369

### E-MAIL

info@astronpumpsindia.com  
sales@astronpumpsindia.com

For further information,  
Visit : [www.astronpumpsindia.com](http://www.astronpumpsindia.com)

AUTHORISED DEALER / DISTRIBUTOR



Scan to download PDF

